

Technical Data Sheet



BETTELUX WALL MOUNTED WASHBASIN

Wall mounted washbasin rectangular, 800 x 495 x 140 mm, enamelled, with a taphole, without an overflow, incl. fastening material

Design: Tesseraux + Partner

article no.	A167 HLW1
dimension	80 x 49,5 x 14 cm
Colours	can be delivered in white, exclusive colours and other sanitary colours
Extras	available with the easy-to-clean surface BETTEGLAZE® PLUS

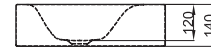
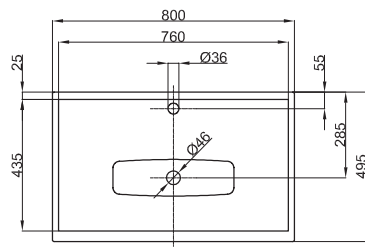

Recommended taps

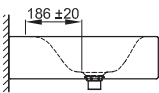

spout projection:
ca. 186 mm from centre of taphole

Dimensions for installation and connection

